

FLAT

 ISOMETRIC VIEW



acurlite
 Structural Skylights, Inc.
 www.acurlite.com sales@acurlite.com

© NOV 20, 2017

570.759.6882 www.acurlite.com sales@acurlite.com

**EZ LITE
 SYSTEM
 DETAILS**

SCALE:
 N.T.S.

DRAWN BY:
 K.A.M.

CHECKED BY:
 C.H.M.

DATE - ISSUE:
 11/20/17 - A

SHEET:
SAMPLE

GENERAL NOTES

• PRE-ASSEMBLED - PRE-GLAZED - EZ TO INSTALL

ALL UNITS SHIP FROM ACURLITE'S FACTORY COMPLETE AND READY TO INSTALL ON, A PRE-ENGINEERED CURB BY OTHERS. ACURLITE PROVIDES THE REQUIRED ZINC PERIMETER CURB FASTENERS, DOW CORNING 795 SILICONE FOR BED SEALANT STANDARD WITH ALL UNITS.

• CUSTOM SHAPES & SIZES - PER PROJECT REQ.

ACURLITE'S SYSTEM IS DESIGNED AND ENGINEERED TO BE VERSATILE. EACH SKYLIGHT IS ENGINEERED TO MEET OR EXCEED THE PROJECT'S SPECIFIC REQUIREMENTS. PLEASE CONSULT OUR FACTORY REGARDING CAPABILITIES AND AVAILABILITY OF YOUR NEEDS.

GEOMETRY:

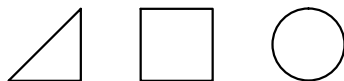

MINIMUM SIZE:

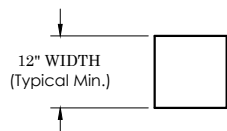

MAXIMUM SIZE:

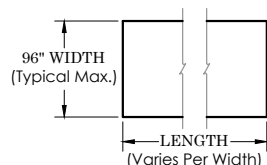

PER PROJECT SPECIFIC LOADING REQUIREMENTS, SHIPPING, SITE LOGISTICS & GLAZING FABRICATION CAPABILITIES.

• PROJECT SPECIFIC ACCOMMODATION

ALL DESIGN PARAMETERS AND DETAILS HEREIN ARE FOR REFERENCE ONLY AND SUBJECT TO CHANGE PER ACURLITE PROJECT PROPOSAL, SPECIFIC SITE CONDITIONS, ACURLITE P.E. ANALYSIS, AND GOVERNING CODE REQUIREMENTS. PLEASE CONSULT FACTORY FOR PROJECT SPECIFIC DETAILS.

1. WARRANTY

ACURLITE MATERIAL WARRANTY COVERS ALL ASSEMBLY AND SEALING PERFORMED IN OUR FACTORY. PASS THROUGH WARRANTY PROVIDED FOR FINISH AND GLAZING PER VENDOR / MANUFACTURER. ACURLITE CANNOT TAKE RESPONSIBILITY, NOR WARRANTY INSTALLATION, MODIFICATION AND/OR DAMAGE BY OTHER PARTIES. PLEASE REFER TO ACURLITE WARRANTY DOCUMENT FOR COMPLETE DETAILS.

2. INSTALLATION

NOTES & DETAILS HEREIN ARE FOR REFERENCE ONLY. PLEASE REFER TO ACURLITE'S EZ-LITE INSTALLATION MANUAL FOR COMPLETE DETAILS REGARDING INSTALLATION AND MAINTENANCE PROCEDURES.

3. OPTIONS

FULL RANGE OF STANDARD/CUSTOM COLORS AND FINISH TYPES ARE AVAILABLE UPON REQUEST.

GLASS THICKNESS RANGE FROM 5/16" TO 1-5/16" REQUIRED THICKNESS PER AAMA GUIDELINES MAKE UP PER ARCHITECT / PROJECT SPECIFICATION.

CONSULT FACTORY FOR PROJECT SPECIFIC REQUIREMENTS REGARDING ADDED INSULATION, CURB ATTACHMENT, ETC.

4. CURB BY OTHERS

CURB MUST RESIST ALL LOADS / REACTIONS IMPOSED BY SKYLIGHT. ACURLITE TO PROVIDE P.E. STAMPED CALCULATIONS, NOTING THOSE SPECIFIC LOADS / REACTIONS IMPOSED ON THE CURB. THE RESPONSIBLE ENGINEER OF RECORD TO VERIFY AND APPROVE.

CURB MUST BE SLOPED TOWARDS SILL / WEEPS TO PROVIDE PROPER SYSTEM DRAINAGE. MINIMUM SLOPE REQUIRED 4.76° / 1:12 - NOT BY ACURLITE - PROVIDED BY OTHERS.

SOME LOCAL CODES MAY DICTATE THE CURB BE CONSTRUED OF MATERIALS DIFFERENT THAN DETAILED ON THESE DRAWINGS. PLEASE CONSULT FACTORY FOR YOUR SPECIFIC NEEDS.



acurlite
Structural Skylights, Inc.
sales@acurlite.com

© NOV 20, 2017

570.759.6882 www.acurlite.com

**EZ LITE
SYSTEM
DETAILS**

SCALE:

N.T.S.

DRAWN BY:

K.A.M.

CHECKED BY:

C.H.M.

DATE - ISSUE:

11/20/17 - A

SHEET:

D0



acurlite
Structural Skylights, Inc.

sales@acurlite.com
www.acurlite.com
570.759.6882

© NOV 20, 2017

EZ LITE SYSTEM DETAILS

SCALE:

6" = 1' - 0"

DRAWN BY:

K.A.M.

CHECKED BY:

C.H.M.

DATE - ISSUE:

11/20/17 - A

SHEET:

D1

12
1 | 4.76° MIN.

FACTORY ASSEMBLY¹

EXTRUDED CURB CAP
W/ GASKET & CONTINUOUS SEAL
(Dow Corning 795 Silicone Applied)

BACKER ROD & CONTINUOUS SEAL
(Dow Corning 795 Silicone Applied)

SILICONE SETTING BLOCK
(Located At Quarter Points - 2 Per Bay)

EXTRUDED ALUM. CURB CAP

.100" MIN. THICKNESS
(Typical Structural Members)

CURB CAP FASTENED TO CURB
SETTING BLOCK AT EACH LOCATION
(Fastener Size, Type & Locations T.B.D.)
(Per Acurlite P.E. Analysis)

CONTINUOUS SEAL
(Dow Corning 795 Silicone Applied)

1/4" WEEP HOLE & COVER
(Located As Required)

THERMAL BREAK
(Pour & Debridge)

INSTALLATION²

FASTEN SKYLIGHT TO CURB
SHIM IF REQUIRED
(Fastener Size, Type & Locations T.B.D. - Provided)
(Per Acurlite P.E. Analysis - Provided)

SET SKYLIGHT IN BED OF SEALANT
(Use Dow Corning 795 Silicone - Provided)

ISOLATION / WATERPROOF MEMBRANE
(Details Per Contract Documents)
(Not By Acurlite - Provided By Others)

OPTIONS³

STANDARD & CUSTOM FINISHES
(Paint, Anodize & Powder Coat Available)

INSULATED LAMINATED / LAMINATED GLAZING
(Various Low-E, Tint, Frit, And/Or Dynamic Glass Available)
(Required Thickness Per AAMA Guidelines)

MINERAL WOOL INSULATION
(Provided For Additional Cost)

FACTORY CONT.¹

SILICONE GASKET

CONTINUOUS STRUCTURAL SEAL IF REQUIRED
(Dow Corning 995 Structural Silicone Applied)

EXTRUDED ALUM. SEAL FLANGE
FASTENED TO EXTRUDED CURB IF REQUIRED
(Fastener Size, Type & Locations T.B.D.)
(Per Acurlite P.E. Analysis)

EXTRUDED ALUM. CURB
(Reinforcement As Required)
(Per Acurlite P.E. Analysis)

PLEASE NOTE⁴

CURB MUST RESIST ALL LOADS / REACTIONS
IMPOSED BY SKYLIGHT
(Reactions Provided By Acurlite P.E.)
(Responsible E.O.R. To Verify And Approve)

CURB MUST BE SLOPED TOWARD SILL
TO PROVIDE PROPER DRAINAGE
(4.76° / 1:12 Min. Pitch Required)
(Not By Acurlite - Provided By Others)

CURB & SUBSTRUCTURE
(Details / Makeup Per Contract Documents)
(Not By Acurlite - Provided By Others)

OUT TO OUT OF CURB
(Please Verify)

D1 SILL
TYPICAL DETAIL



acurlite
Structural Skylights, Inc.

sales@acurlite.com
www.acurlite.com
570.759.6882

© NOV 20, 2017

**EZ LITE
SYSTEM
DETAILS**

SCALE:
6" = 1' - 0"

DRAWN BY:
K.A.M.

CHECKED BY:
C.H.M.

DATE - ISSUE:
11/20/17 - A

SHEET:
D2

12
1 | 4.76° MIN.

OPTIONS³

STANDARD & CUSTOM FINISHES
(Paint, Anodize & Powder Coat Available)

INSULATED LAMINATED / LAMINATED GLAZING
(Various Low-E, Tint, Frit, And/Or Dynamic Glass Available)
(Required Thickness Per AAMA Guidelines)

MINERAL WOOL INSULATION
(Provided For Additional Cost)

FACTORY ASSEMBLY¹

**EXTRUDED CURB CAP
W/ GASKET & CONTINUOUS SEAL**
(Dow Corning 795 Silicone Applied)

SILICONE EDGE BLOCK
.100" MIN. THICKNESS
(Typical Structural Members)

SILICONE GASKET

EXTRUDED ALUM. CURB
(Reinforcement As Required)
(Per Acurlite P.E. Analysis)

**CURB CAP FASTENED TO CURB
SETTING BLOCK AT EACH LOCATION**
(Fastener Size, Type & Locations T.B.D)
(Per Acurlite P.E. Analysis)

CONTINUOUS SEAL
(Dow Corning 795 Silicone Applied)

THERMAL BREAK
(Pour & Debridge)

INSTALLATION²

**FASTEN SKYLIGHT TO CURB
SHIM IF REQUIRED**
(Fastener Size, Type & Locations T.B.D. - Provided)
(Per Acurlite P.E. Analysis - Provided)

SET SKYLIGHT IN BED OF SEALANT
(Use Dow Corning 795 Silicone - Provided)

ISOLATION / WATERPROOF MEMBRANE
(Details Per Contract Documents)
(Not By Acurlite - Provided By Others)

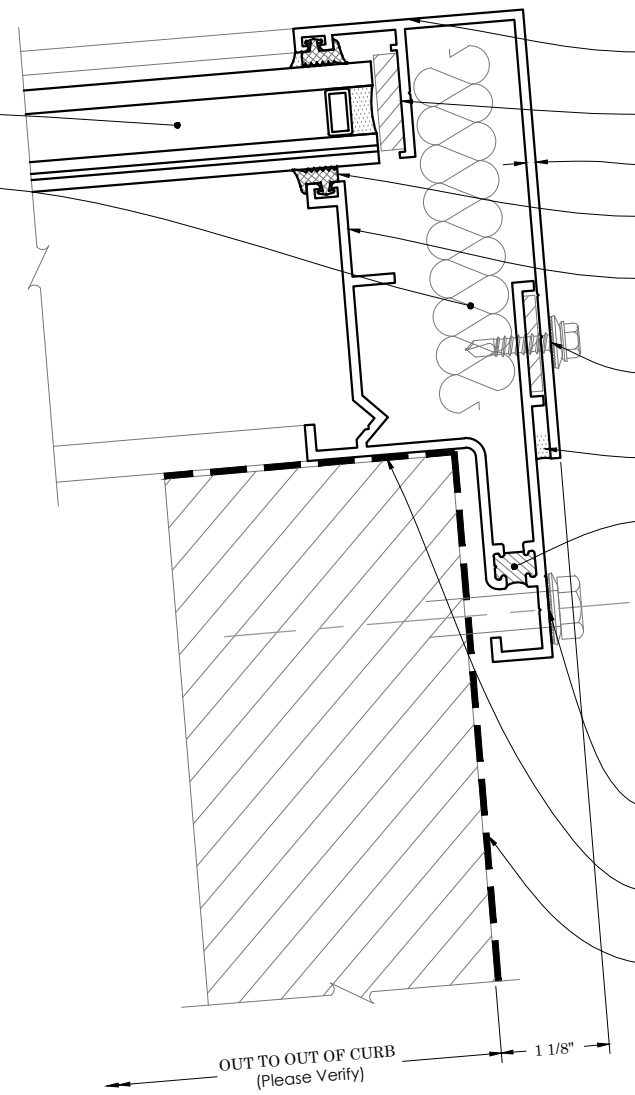

PLEASE NOTE⁴

**CURB MUST RESIST ALL LOADS / REACTIONS
IMPOSED BY SKYLIGHT**
(Reactions Provided By Acurlite P.E.)
(Responsible E.O.R. To Verify And Approve)

**CURB MUST BE SLOPED TOWARD SILL
TO PROVIDE PROPER DRAINAGE**
(4.76° / 1:12 Min. Pitch Required)
(Not By Acurlite - Provided By Others)

CURB & SUBSTRUCTURE
(Details / Makeup Per Contract Documents)
(Not By Acurlite - Provided By Others)

D2 ————— **RIDGE**
TYPICAL DETAIL



acurlite
Structural Skylights, Inc.

sales@acurlite.com
www.acurlite.com
570.759.6882

© NOV 20, 2017

EZ LITE SYSTEM DETAILS

SCALE:

6" = 1' - 0"

DRAWN BY:

K.A.M.

CHECKED BY:

C.H.M.

DATE - ISSUE:

11/20/17 - A

SHEET:

D3

FACTORY ASSEMBLY¹

EXTRUDED CURB CAP
W/ GASKET & CONTINUOUS SEAL
(Dow Corning 795 Silicone Applied)

SILICONE EDGE BLOCK

.100" MIN. THICKNESS
(Typical Structural Members)

SILICONE GASKET

EXTRUDED ALUM. CURB
(Reinforcement As Required)
(Per Acurlite P.E. Analysis)

CURB CAP FASTENED TO CURB
SETTING BLOCK AT EACH LOCATION
(Fastener Size, Type & Locations T.B.D.)
(Per Acurlite P.E. Analysis)

CONTINUOUS SEAL
(Dow Corning 795 Silicone Applied)

THERMAL BREAK
(Pour & Debridge)

INSTALLATION²

FASTEN SKYLIGHT TO CURB
SHIM IF REQUIRED
(Fastener Size, Type & Locations T.B.D. - Provided)
(Per Acurlite P.E. Analysis - Provided)

SET SKYLIGHT IN BED OF SEALANT
(Use Dow Corning 795 Silicone - Provided)

ISOLATION / WATERPROOF MEMBRANE
(Details Per Contract Documents)
(Not By Acurlite - Provided By Others)

OPTIONS³

STANDARD & CUSTOM FINISHES
(Paint, Anodize & Powder Coat Available)

INSULATED LAMINATED / LAMINATED GLAZING
(Various Low-E, Tint, Frit, And/Or Dynamic Glass Available)
(Required Thickness Per AAMA Guidelines)

MINERAL WOOL INSULATION
(Provided For Additional Cost)

PLEASE NOTE⁴

CURB MUST RESIST ALL LOADS / REACTIONS
IMPOSED BY SKYLIGHT
(Reactions Provided By Acurlite P.E.)
(Responsible E.O.R. To Verify And Approve)

CURB MUST BE SLOPED TOWARD SILL
TO PROVIDE PROPER DRAINAGE
(4.76° / 1:12 Min. Pitch Required)
(Not By Acurlite - Provided By Others)

CURB & SUBSTRUCTURE
(Details / Makeup Per Contract Documents)
(Not By Acurlite - Provided By Others)

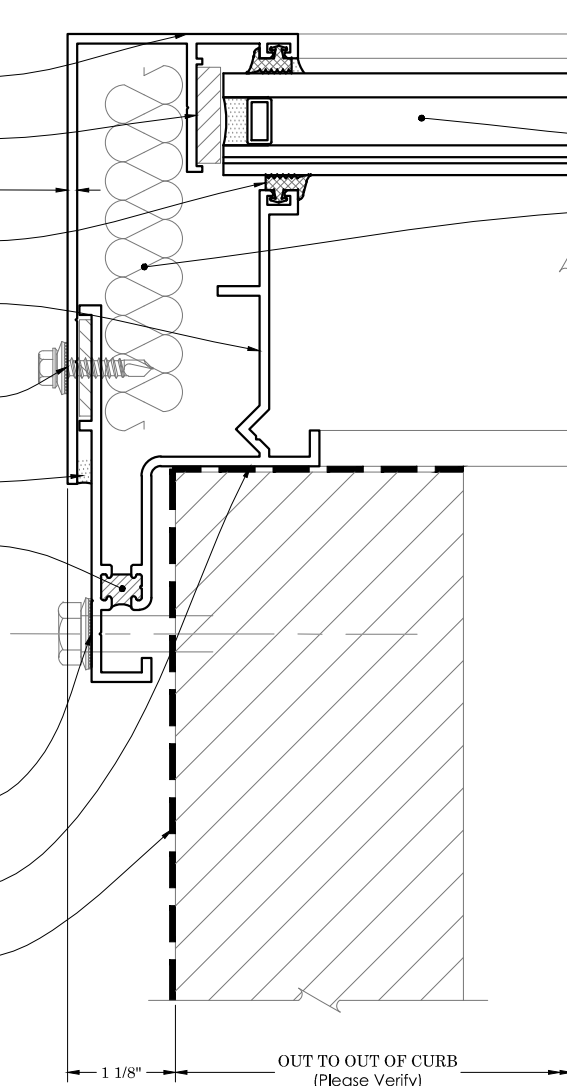

D3

JAMB
TYPICAL DETAIL